

**FLOOR PLAN**

**1**

**GROUND FLOOR**

SCALE: NTS

ARCH REF: 1/A-110  
 1/A-111  
 1/A-112

QUANTITY: TYPE F1 - 36  
 TYPE F2 - 11  
 TYPE ID2 - 1

KAWNEER IR-501 IMPACT ALUMINUM STOREFRONT  
 KAWNEER IR-1600, SYSTEM 1, IMPACT ALUMINUM CURTAIN WALL  
 KAWNEER TRIFAB VG-450 ALUMINUM STOREFRONT  
 KAWNEER 350-IR MEDIUM STILE IMPACT ALUMINUM ENTRANCE

TYPE F3 - 1    TYPE F4A - 1    TYPE F4B - 1    TYPE F5 - 1    TYPE F6 - 1  
 TYPE ID5 - 15    TYPE MR1 - 4    TYPE MR2 - 2



DATE	BY	DESCRIPTION
04/28/23	fp	First Submittal
1	SUB	

**EVINS GLASS SERVICE, INC**  
 101 N.P.I.D., CORPUS CHRISTI, TX 78406  
 WORK (361) 884-3995    FAX (361) 884-4262

PROJECT: LYB-CCO EQUISTAR CHEMICALS  
**LABORATORY AND OFFICE COMPLEX**  
 ARCHITECT: BURROW GLOBAL  
 (713) 963-9880  
 GENERAL CONTRACTOR: BURROW GLOBAL  
 (713) 963-9890

PROJECT NO.	EGS-2304-02
DRAWN BY	fp
DATE	04/28/23
SCALE	NTS
DRAWING	FLOOR PLANS
SHEET	P1

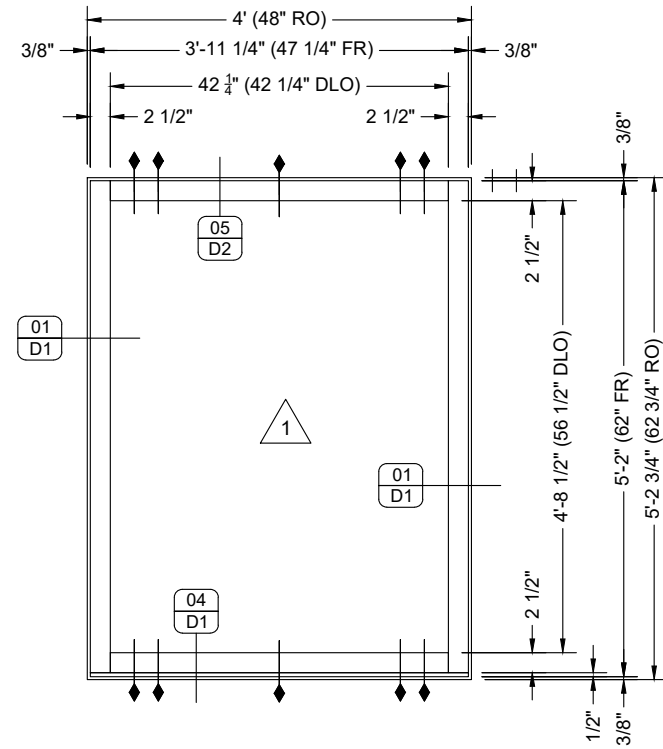

**ELEVATION**

QUANTITY: 36  
 SCALE: 1/2" = 1'-0"  
 ARCH REF: 1/A-111  
 1/A-112  
 1/A-201  
 F1/A-602

**F1**

**EXT STOREFRONT**

KAWNEER IR501 IMPACT ALUMINUM STOREFRONT

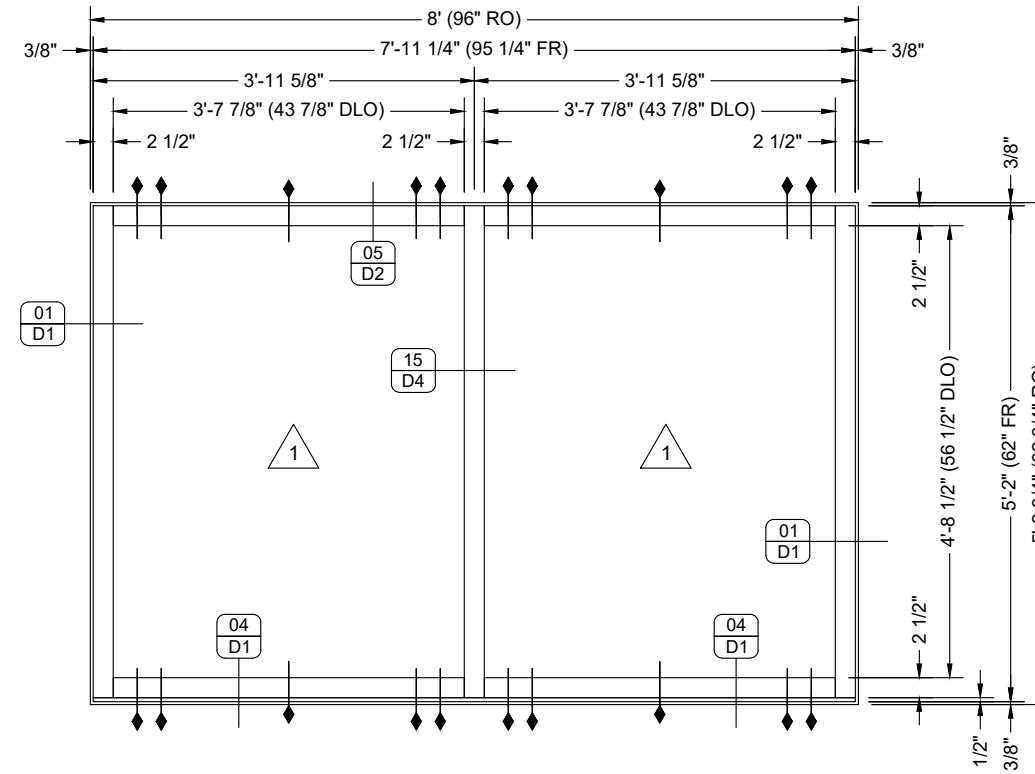

**ELEVATION**

QUANTITY: 11  
 SCALE: 1/2" = 1'-0"  
 ARCH REF: 1/A-111  
 1/A-112  
 1/A-201  
 2/A-201  
 F2/A-602

**F2**

**EXT STOREFRONT**

KAWNEER IR501 IMPACT ALUMINUM STOREFRONT

NO.	DATE	DESCRIPTION
1	04/28/23	First Submittal

**EVINS GLASS SERVICE, INC**  
 101 N.P.I.D., CORPUS CHRISTI, TX 78406  
 WORK (361) 884-3995 FAX (361) 884-4262

PROJECT: LYB-CO EQUJSTAR CHEMICALS  
**LABORATORY AND OFFICE COMPLEX**  
 ARCHITECT: BURROW GLOBAL  
 (713) 965-0800  
 GENERAL CONTRACTOR: BURROW GLOBAL  
 (713) 965-0800

PROJECT NO.	EGS-2304-02
DRAWN BY	fp
DATE	04/28/23
SCALE	1/2" = 1'-0"
DRAWING	ELEVATIONS
SHEET	E1

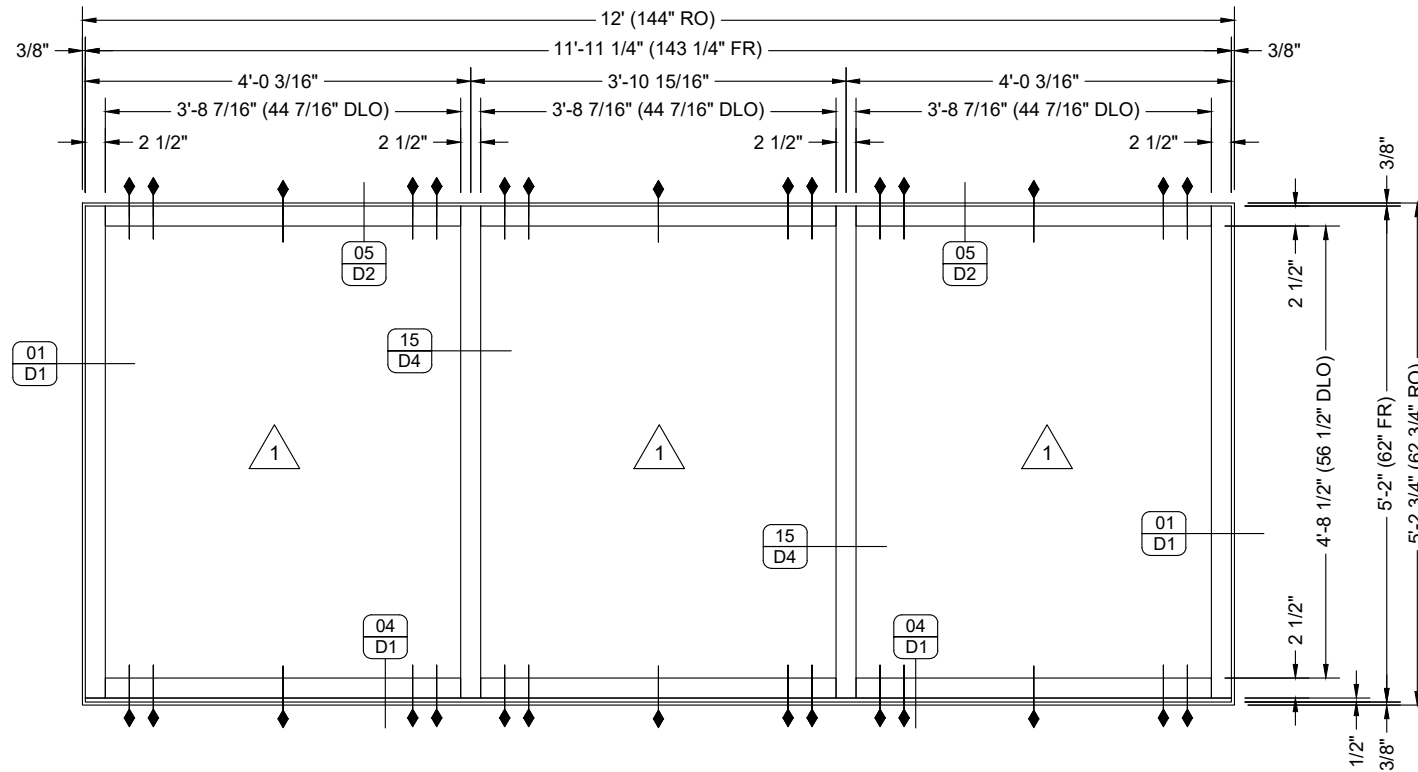

**ELEVATION**

QUANTITY: 01  
 SCALE: 1/2" = 1'-0"  
 ARCH REF: 1/A-111  
 1/A-202  
 F3/A-602



**F3 EXT STOREFRONT**

KAWNEER IR501 IMPACT ALUMINUM STOREFRONT

DATE	DESCRIPTION
04/28/23	First Submittal
fp	BY
1	SUB

**EVINS GLASS SERVICE, INC**  
 101 N.P.I.D., CORPUS CHRISTI, TX 78406  
 WORK (361) 884-3995 FAX (361) 884-4262

PROJECT: LYB-CO EQUJSTAR CHEMICALS  
**LABORATORY AND OFFICE COMPLEX**  
 ARCHITECT: BURROW GLOBAL  
 (713) 962-0800  
 GENERAL CONTRACTOR: BURROW GLOBAL  
 (713) 962-0800

PROJECT NO.	EGS-2304-02
DRAWN BY	fp
DATE	04/28/23
SCALE	1/2" = 1'-0"
DRAWING	ELEVATIONS
SHEET	E2

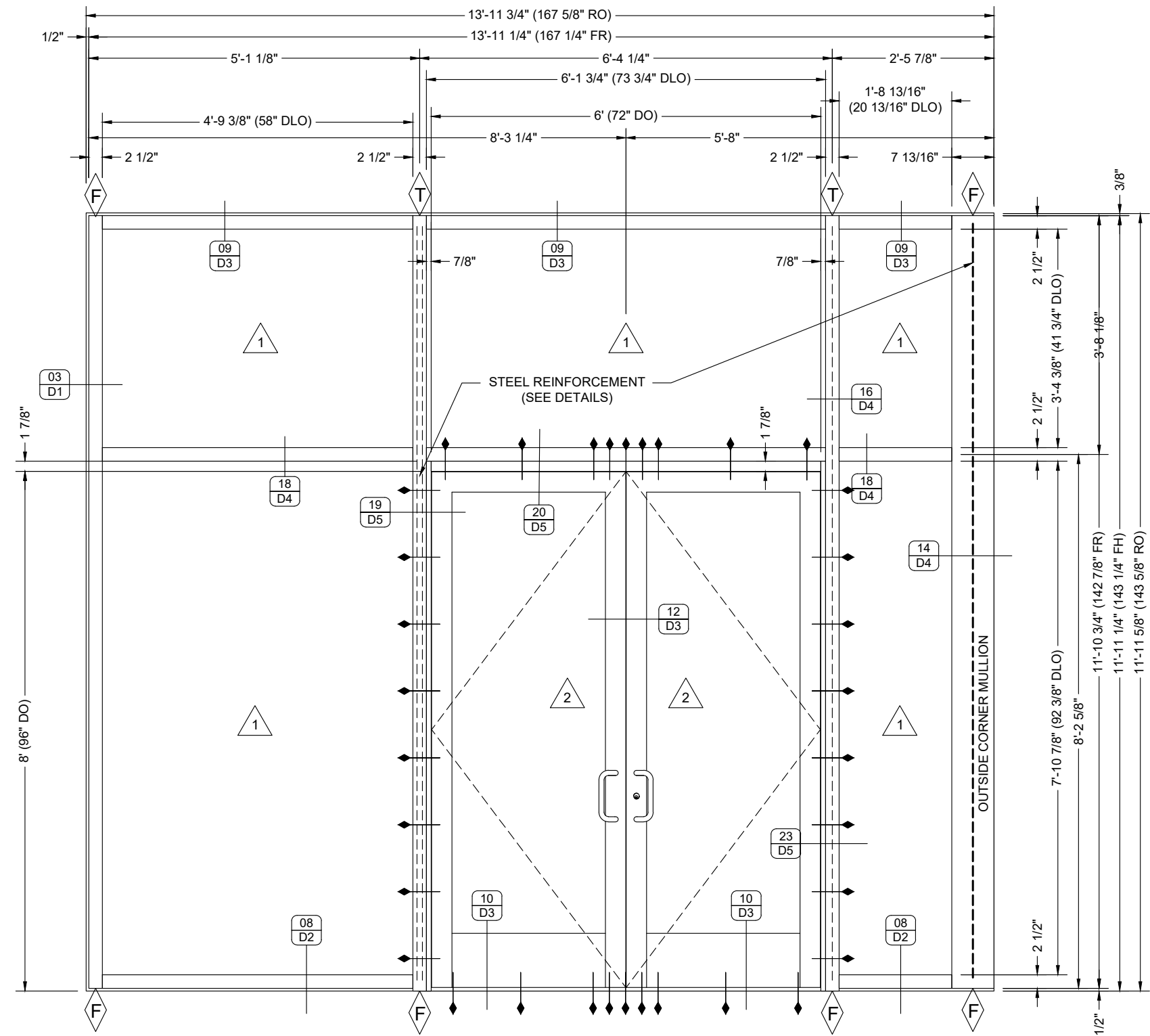

**HARDWARE: DOOR 101A, SET 21**

AS REQD OFFSET PIVOTS BY STOREFRONT MANUF TO MEET BLAST REQUIREMENTS  
 2 EA POWER TRANSFER AT INTERMEDIATE PIVOT BY STOREFRONT MANUF  
 2 EA ELECTRIFIED CONCEALED ROD EXIT DEVICE WITH EXTERIOR CYLINDER BY STOREFRONT MANUF  
 2 EA I/C CYLINDER AS REQUIRED 626 BEST  
 1 EA CLOSER CPS7500 689 NORTON-RIXSON  
 1 EA POWER SUPPLY BY STOREFRONT MANUF  
 2 EA SWEEPBY STOREFRONT MANUF  
 1 EA THRESHOLD BY STOREFRONT MANUF  
 2 EA POSITION SWITCH DPS-M GRY SECURITRON  
 \*\*CARD READER BY SECURITY SUPPLIER.  
 \*\*PROVIDE HARNESS AS APPROPRIATE FOR DOOR SIZE.  
 \*\*SEALS AND SWEEPS BY DOOR SUPPLIER.  
 \*\*PROVIDE DROP PLATES AND BLADE STOP SPACERS AS REQUIRED FOR CLOSER INSTALLATION.  
 \*\*HARDWARE LISTED IS BASIS OF DESIGN FOR BLAST DOOR HARDWARE.  
 PROVIDE HARDWARE COMPATIBLE AND TO MEET BLAST RESISTANT REQUIREMENTS OF DOOR SUPPLIER.  
 OPERATION: DOORS NORMALLY LOCKED AND CLOSED. VALID CARD READ ACTIVATES ELECTRIC LATCH RETRACTION EXIT DEVICES TO ALLOW ENTRY. VALID CARD READ ALSO ACTIVATES OUTSIDE AUTOMATIC OPERATOR ACTUATOR TO ALLOW AUTOMATIC OPERATOR ENTRANCE. FREE EGRESS IS ALWAYS ALLOWED.

**ELEVATION**

QUANTITY: 01  
 SCALE: 1/2" = 1'-0"  
 ARCH REF: 1/A-112  
 F4/A-602  
 DS/A-603



**EXT STOREFRONT**

KAWNEER IR-1600 IMPACT ALUMINUM CURTAIN WALL  
 KAWNEER 350-IR IMPACT MEDIUM STILE ALUMINUM ENTRANCE

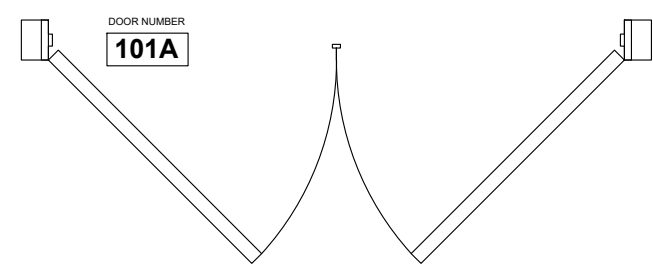

NO.	DATE	BY	DESCRIPTION
1	04/28/23	fp	First Submittal

**EVINS GLASS SERVICE, INC**  
 101 N.P.I.D., CORPUS CHRISTI, TX 78406  
 WORK (361) 884-3995 FAX (361) 884-4262

PROJECT: LYB-CO EQUJSTAR CHEMICALS  
**LABORATORY AND OFFICE COMPLEX**  
 ARCHITECT: BURROW GLOBAL (713) 963-0800  
 GENERAL CONTRACTOR: BURROW GLOBAL (713) 963-0800

PROJECT NO. EGS-2304-02	
DRAWN BY fp	DATE 04/28/23
SCALE 1/2" = 1'-0"	
DRAWING ELEVATIONS	
SHEET E3	

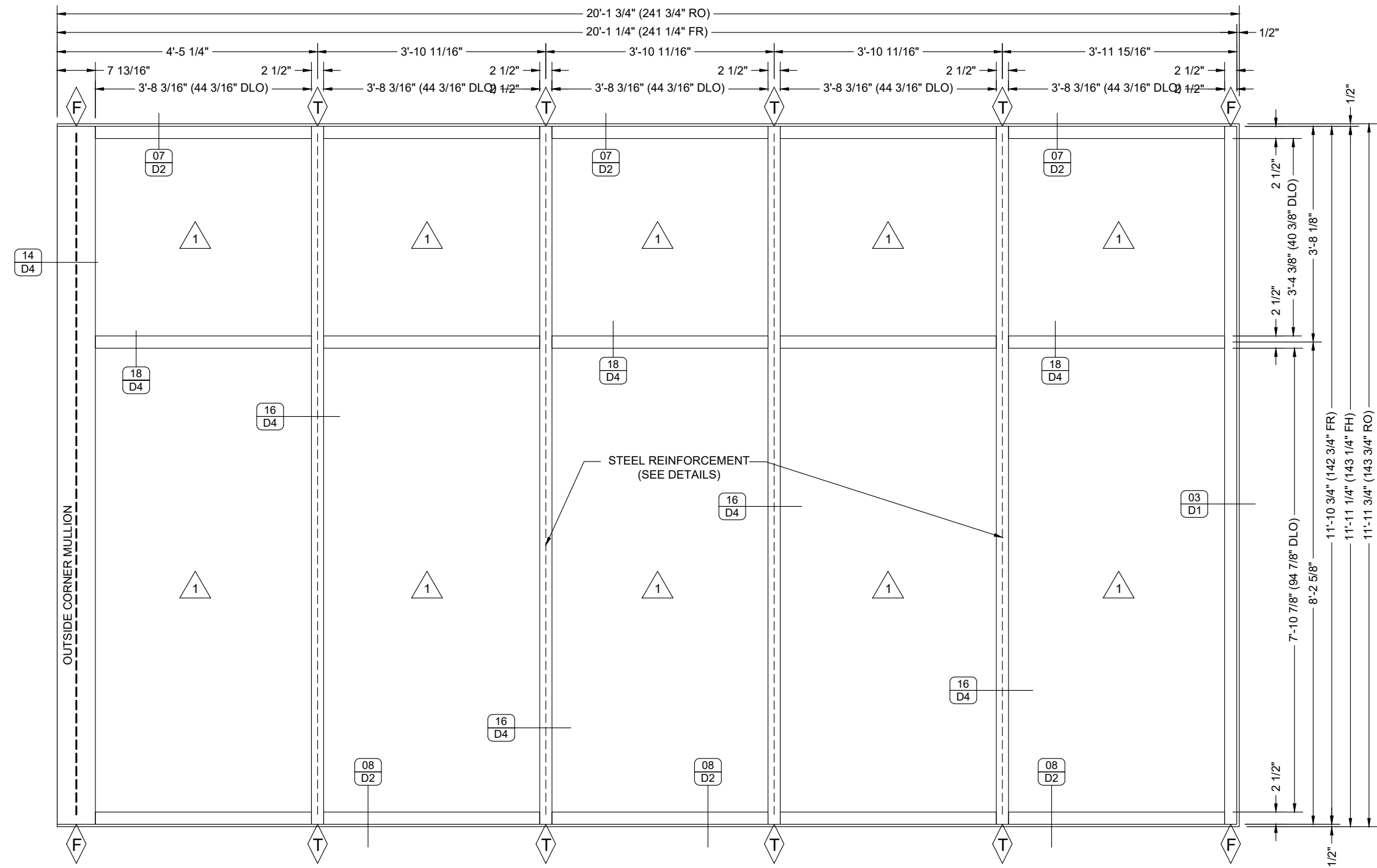

**ELEVATION**

QUANTITY: 01  
 SCALE: 1/2" = 1'-0"  
 ARCH REF: 1/A-112  
 1/A-201  
 F4/A-602



**EXT STOREFRONT**

KAWNEER 1600-IR, SYSTEM 1, IMPACT ALUMINUM CURTAIN WALL

NO.	DATE	DESCRIPTION
1	04/28/23	First Submittal
fp		
SUB	BY	

**EVINS GLASS SERVICE, INC**  
 101 N.P.I.D., CORPUS CHRISTI, TX 78406  
 WORK (361) 884-3995 FAX (361) 884-4262

PROJECT: LYB-CO EQUJSTAR CHEMICALS  
**LABORATORY AND OFFICE COMPLEX**  
 ARCHITECT: BURROW GLOBAL  
 (713) 965-0800  
 GENERAL CONTRACTOR: BURROW GLOBAL  
 (713) 965-0800

PROJECT NO.	EGS-2304-02
DRAWN BY	fp
DATE	04/28/23
SCALE	1/2" = 1'-0"
DRAWING	ELEVATIONS
SHEET	E4

NO.	DATE	BY	DESCRIPTION
1	04/28/23	fp	First Submittal

**EVINS GLASS SERVICE, INC**  
101 N.P.I.D., CORPUS CHRISTI, TX 78406  
WORK (361) 884-3995 FAX (361) 884-4262

PROJECT: LYB-COO EQUJSTAR CHEMICALS  
**LABORATORY AND OFFICE COMPLEX**  
ARCHITECT: BURROW GLOBAL (713) 963-0830  
GENERAL CONTRACTOR: BURROW GLOBAL (713) 963-0830

PROJECT NO.	EGS-2304-02
DRAWN BY	fp
DATE	04/28/23
SCALE	1/2" = 1'-0"
DRAWING	ELEVATIONS
SHEET	E5

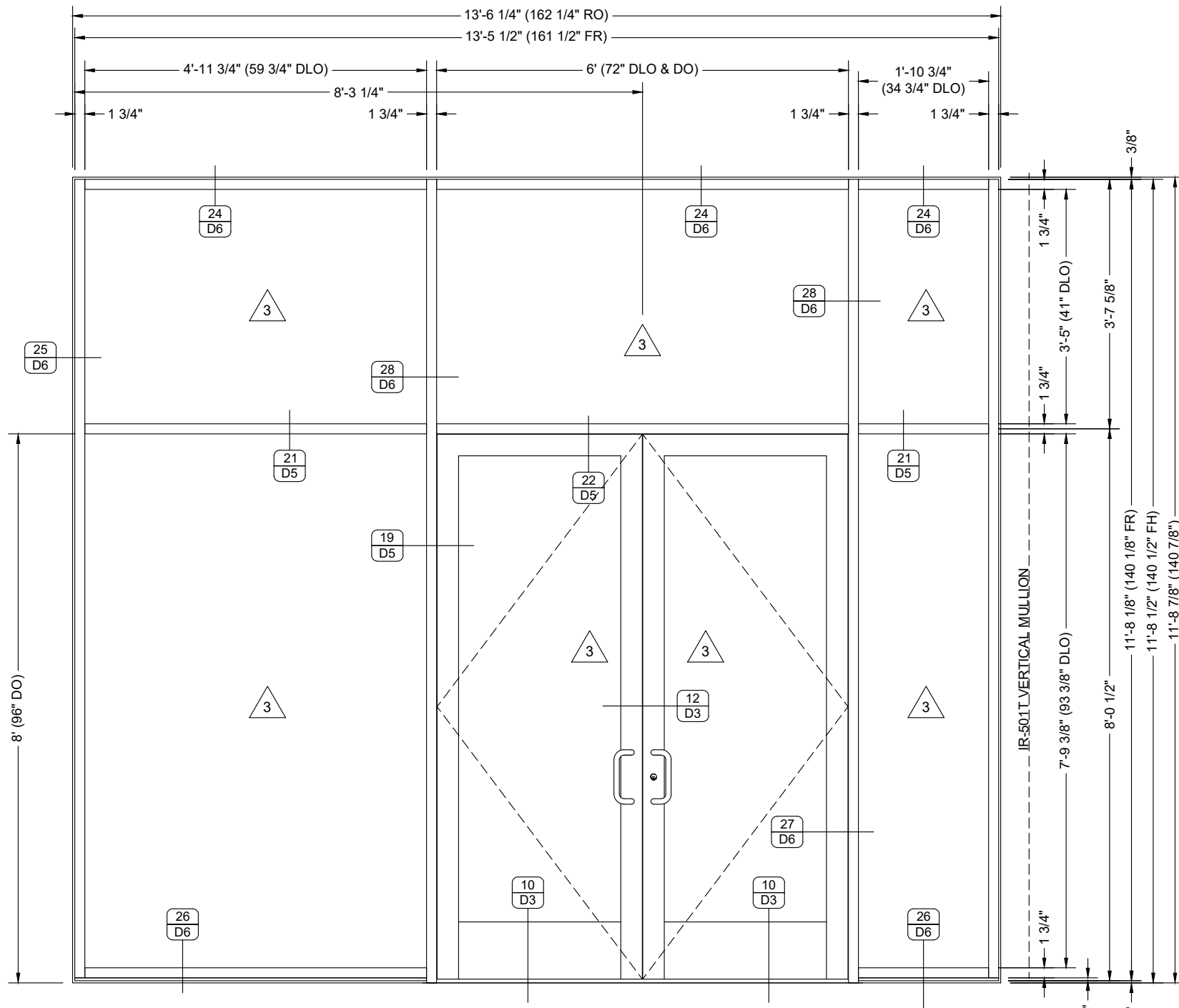

**HARDWARE: DOOR 102A, SET 17**

- 4 EA HINGES T4A3786 - 4.5 X 4.5 652 MCKINNEY
  - 2 EA ELECTRIC HINGE T4A3786 - 4.5 X 4.5 QC12 652 MCKINNEY
  - 2 EA HARNESS QC-C1500/QC-C1500P --- MCKINNEY
  - 2 EA HARNESS QC-CXX/CXXP --- MCKINNEY
  - 1 EA EXIT DEVICE LD-19-55-56-AD8410 X 106 630 SARGENT
  - 1 EA EXIT DEVICE LD-19-55-56-AD8410 630 SARGENT
  - 1 EA CLOSER CPS7500 689 NORTON-RIXSON
  - 1 EA POWER SUPPLY 3540 GRY SARGENT
  - 2 EA POSITION SWITCH DPS-M GRY SECURITRON
  - \*\*CARD READER BY SECURITY SUPPLIER.
  - \*\*PROVIDE HARNESS AS APPROPRIATE FOR DOOR SIZE.
- OPERATION: DOORS NORMALLY LOCKED AND CLOSED. VALID CARD READ ACTIVATES ELECTRIC LATCH RETRACTION EXIT DEVICES TO ALLOW ENTRY. VALID CARD READ ALSO ACTIVATES OUTSIDE AUTOMATIC OPERATOR ACTUATOR TO ALLOW AUTOMATIC OPERATOR ENTRANCE. FREE EGRESS IS ALWAYS ALLOWED.

**ELEVATION**

QUANTITY: 01  
SCALE: 1/2" = 1'-0"  
ARCH REF: 1/A-112  
F5/A-602  
DS/A-603  
HW/A-604

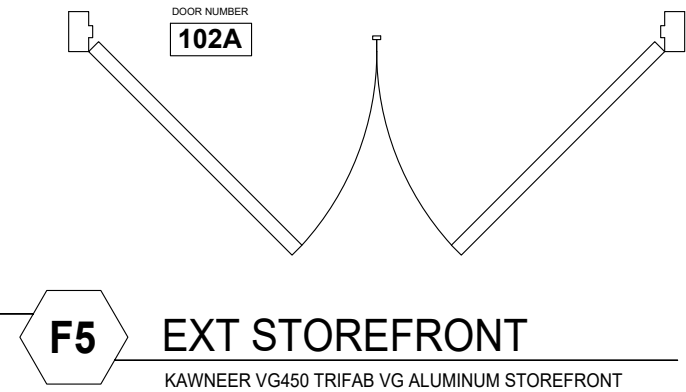

**F5 EXT STOREFRONT**

KAWNEER VG450 TRIFAB VG ALUMINUM STOREFRONT  
KAWNEER 350-IR MEDIUM STILE ENTRANCE

**HARDWARE: DOOR 192B, SET 26**

- AS REQD OFFSET PIVOTS BY STOREFRONT MANUF TO MEET BLAST REQUIREMENTS
  - 1 EA DERA BOTPTOOWME PRR TORTAENCSTFIOERN APTA DINST AECRPM1E1D2BIAL7E PIVOT BY STOREFRONT MANUF
  - 1 EA ELECTRIFIED CONCEALED ROD EXIT DEVICE WITH EXTERIOR CYLINDER BY STOREFRONT MANUF
  - 2 EA IIC CYLINDER AS REQUIRED 626 BEST
  - 1 EA CLOSER CPS7500 689 NORTON-RIXSON
  - 1 EA POWER SUPPLY BY STOREFRONT MANUF
  - 2 EA SWEEPBY STOREFRONT MANUF
  - 1 EA THRESHOLD BY STOREFRONT MANUF
  - 2 EA POSITION SWITCH DPS-M GRY SECURITRON
  - \*\*CARD READER BY SECURITY SUPPLIER.
  - \*\*PROVIDE HARNESS AS APPROPRIATE FOR DOOR SIZE.
  - \*\*SEALS AND SWEEPS BY DOOR SUPPLIER.
  - \*\*PROVIDE DROP PLATES AND BLADE STOP SPACERS AS REQUIRED FOR CLOSER INSTALLATION.
  - \*\*HARDWARE LISTED IS BASIS OF DESIGN FOR BLAST DOOR HARDWARE. PROVIDE HARDWARE COMPATIBLE AND TO MEET BLAST RESISTANT REQUIREMENTS OF DOOR SUPPLIER.
- OPERATION: DOORS NORMALLY LOCKED AND CLOSED. VALID CARD READ ACTIVATES ELECTRIC LATCH RETRACTION EXIT DEVICES TO ALLOW ENTRY. VALID CARD READ ALSO ACTIVATES OUTSIDE AUTOMATIC OPERATOR ACTUATOR TO ALLOW AUTOMATIC OPERATOR ENTRANCE. FREE EGRESS IS ALWAYS ALLOWED.

**ELEVATION**

QUANTITY: 01  
SCALE: 1/2" = 1'-0"  
ARCH REF: 1/A-112  
2/A201  
F6/A-602  
DS/A-603  
HW/A-604

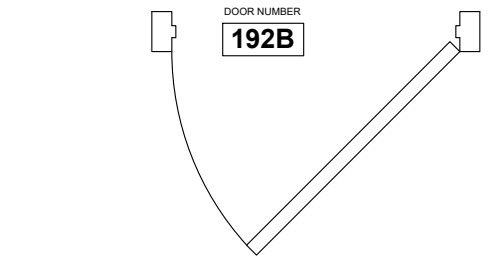
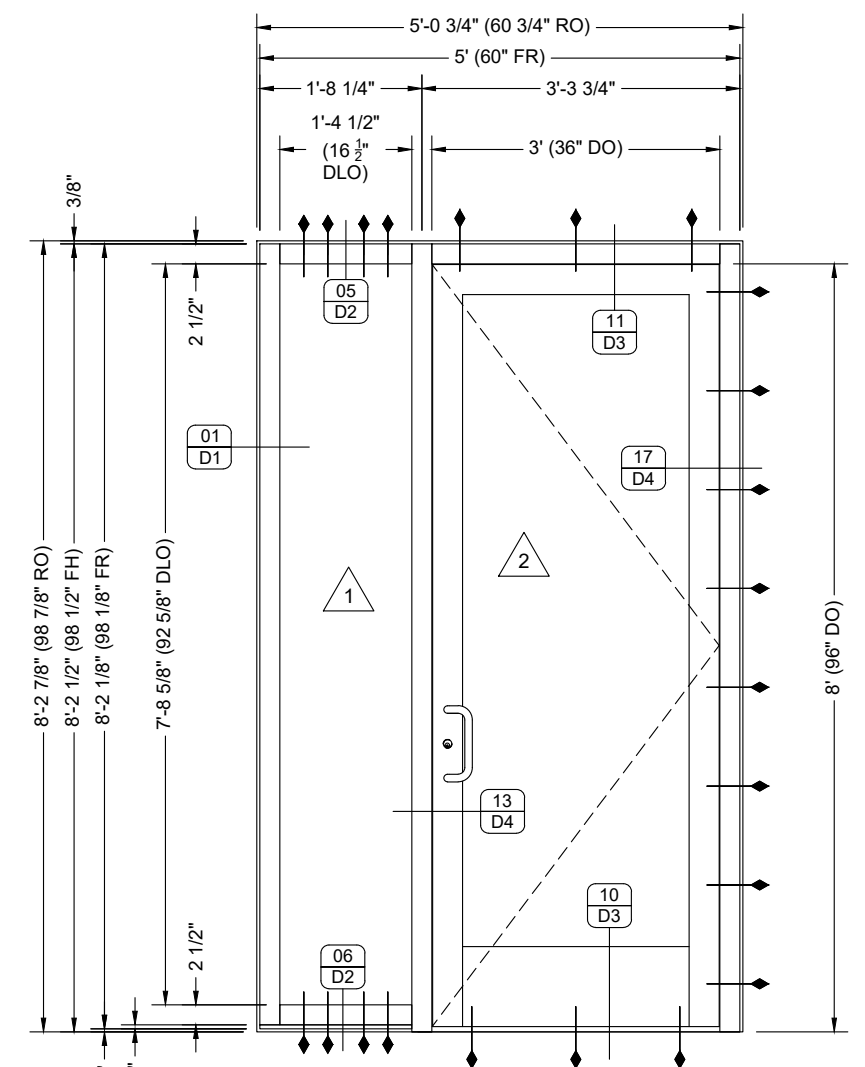

**F6 EXT STOREFRONT**

KAWNEER IR501 IMPACT ALUMINUM STOREFRONT  
KAWNEER 350-IR IMPACT MEDIUM STILE ENTRANCE

DOOR NUMBER  
**101C**

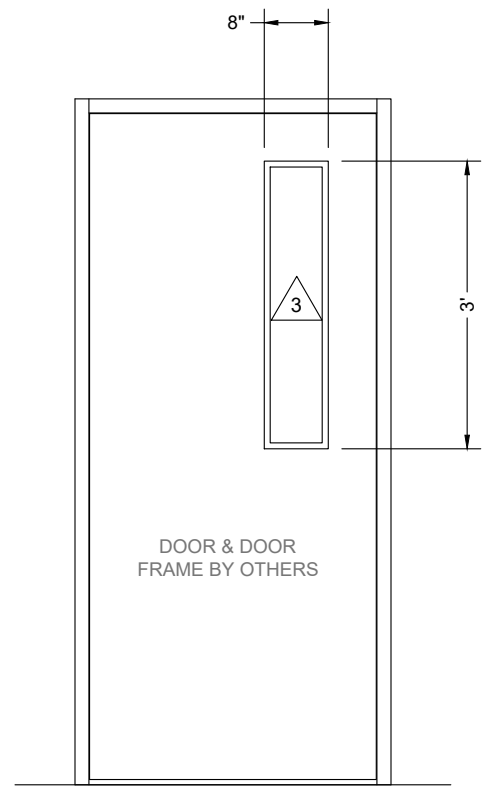

DOOR NUMBERS  
**103A**  
**103B**  
**105A**  
**105B**  
**141A**  
**141B**  
**142A**  
**142B**  
**163B1**  
**163B2**  
**179A**  
**179B**  
**179C**  
**179D**  
**239**

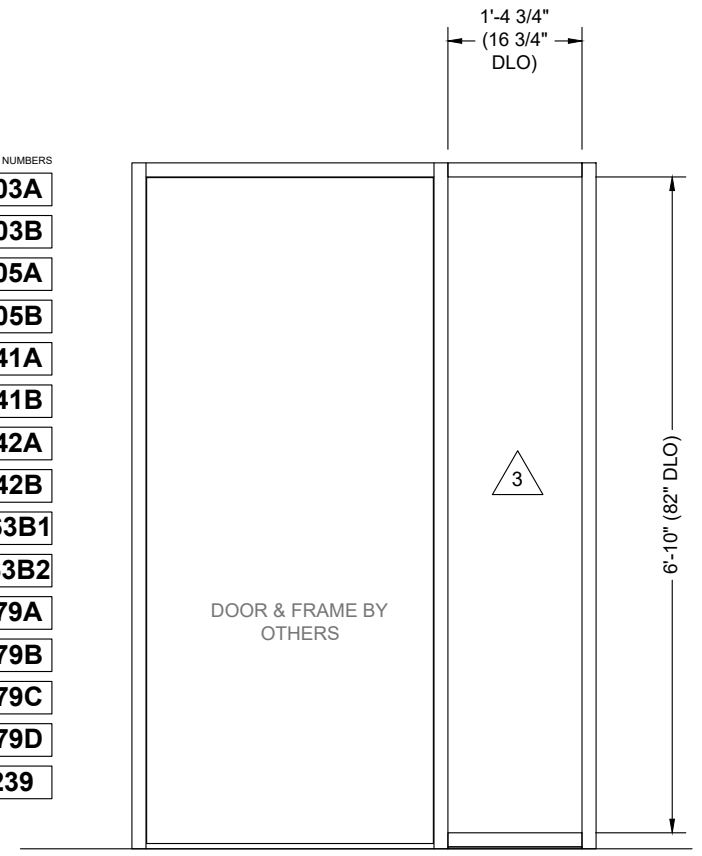

**ELEVATION**

QUANTITY: 01  
 SCALE: 1/2" = 1'-0"  
 ARCH REF: 1/A-112  
 ID2/A-602  
 DS/A-603

**ID2** NARROW WINDOW  
 GLASS ONLY

**ELEVATION**

QUANTITY: 15  
 SCALE: 1/2" = 1'-0"  
 ARCH REF: 1/A-111  
 ID5/A-601  
 DS/A-603

**ID5** SIDELITE  
 GLASS ONLY

NO.	DATE	BY	DESCRIPTION
1	04/28/23	fp	First Submittal

**EVINS GLASS SERVICE, INC**  
 101 N.P.I.D., CORPUS CHRISTI, TX 78406  
 WORK (361) 884-3995 FAX (361) 884-4262

PROJECT  
 LYB-CCO EQUICSTAR CHEMICALS  
**LABORATORY AND OFFICE COMPLEX**  
 ARCHITECT  
 BURROW GLOBAL  
 (713) 965-0800  
 GENERAL CONTRACTOR  
 BURROW GLOBAL  
 (713) 965-0800

PROJECT NO. EGS-2304-02	
DRAWN BY fp	DATE 04/28/23
SCALE 1/2" = 1'-0"	
DRAWING ELEVATIONS	
SHEET E6	

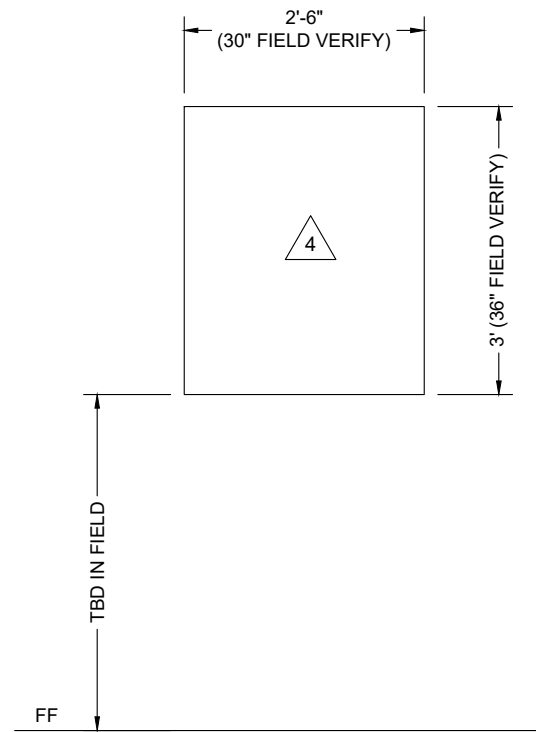
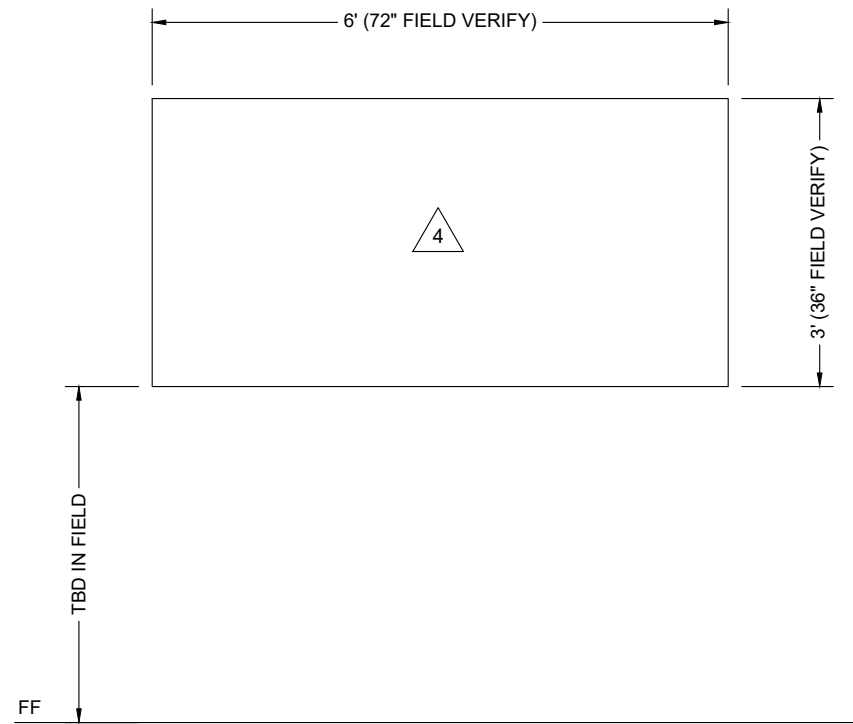

**ELEVATION**

QUANTITY: 04  
 SCALE: 1/2" = 1'-0"  
 ARCH REF: 1/A-401  
 2/A-401  
 4/A-401  
 MR1/A-403



**RESTROOM MIRROR**

FRAMELESS GLASS MIRROR

**ELEVATION**

QUANTITY: 02  
 SCALE: 1/2" = 1'-0"  
 ARCH REF: 1/A-402  
 2/A-402  
 MR1/A-403



**RESTROOM MIRROR**

FRAMELESS GLASS MIRROR

NO.	DATE	BY	DESCRIPTION
1	04/28/23	fp	First Submittal

**EVINS GLASS SERVICE, INC**  
 101 N.P.I.D., CORPUS CHRISTI, TX 78406  
 WORK (361) 884-3995 FAX (361) 884-4262

PROJECT: LYB-CCO EQUICSTAR CHEMICALS  
**LABORATORY AND OFFICE COMPLEX**  
 ARCHITECT: BURROW GLOBAL  
 (713) 965-0800  
 GENERAL CONTRACTOR: BURROW GLOBAL  
 (713) 965-0800

PROJECT NO. EGS-2304-02

DRAWN BY: fp DATE: 04/28/23

SCALE: 1/2" = 1'-0"

DRAWING: ELEVATIONS

SHEET: E7



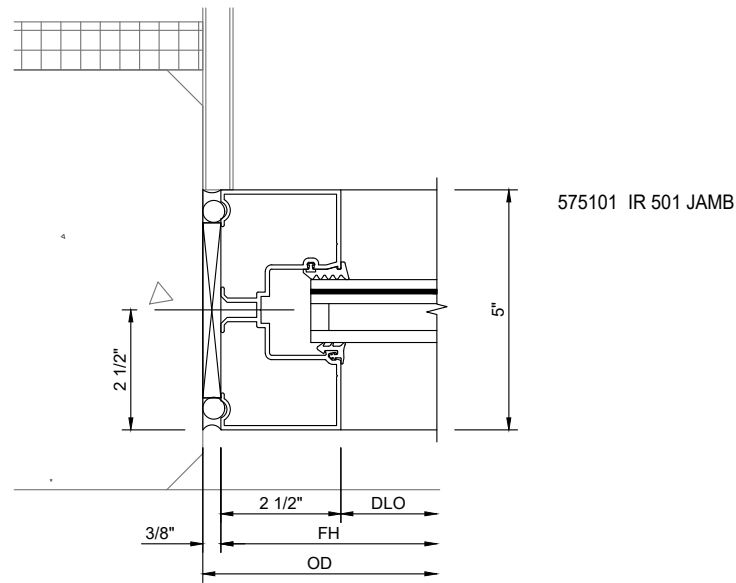

**DETAIL 01 EXT. JAMB**  
SCALE: 3" = 1'-0"  
ARCH REF: 1/A-111  
5/A-510  
**KAWNEER IR-501 IMPACT ALUMINUM STOREFRONT**

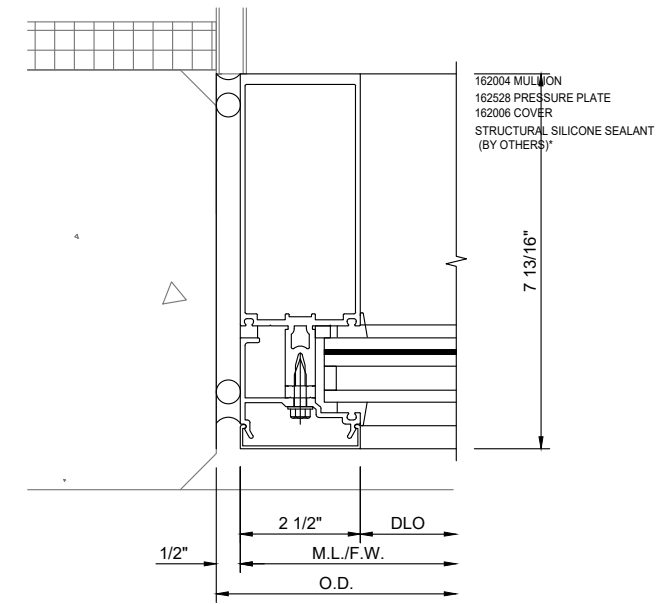

**DETAIL 03 EXT. JAMB**  
SCALE: 3" = 1'-0"  
ARCH REF: 1/A-111  
5/A-510  
**KAWNEER 1600-IR, SYSTEM 1, IMPACT CURTAIN WALL**

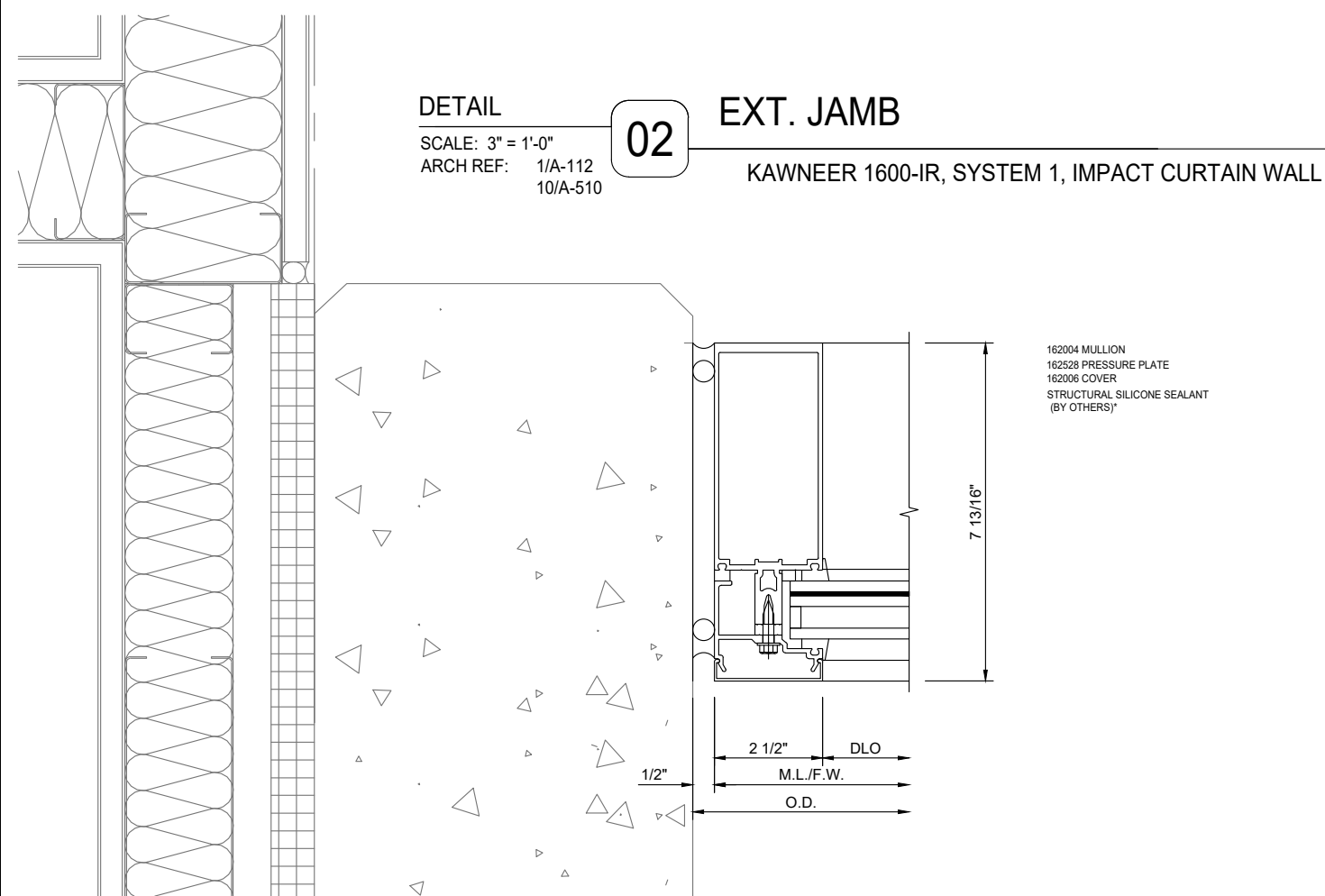

**DETAIL 02 EXT. JAMB**  
SCALE: 3" = 1'-0"  
ARCH REF: 1/A-112  
10/A-510  
**KAWNEER 1600-IR, SYSTEM 1, IMPACT CURTAIN WALL**

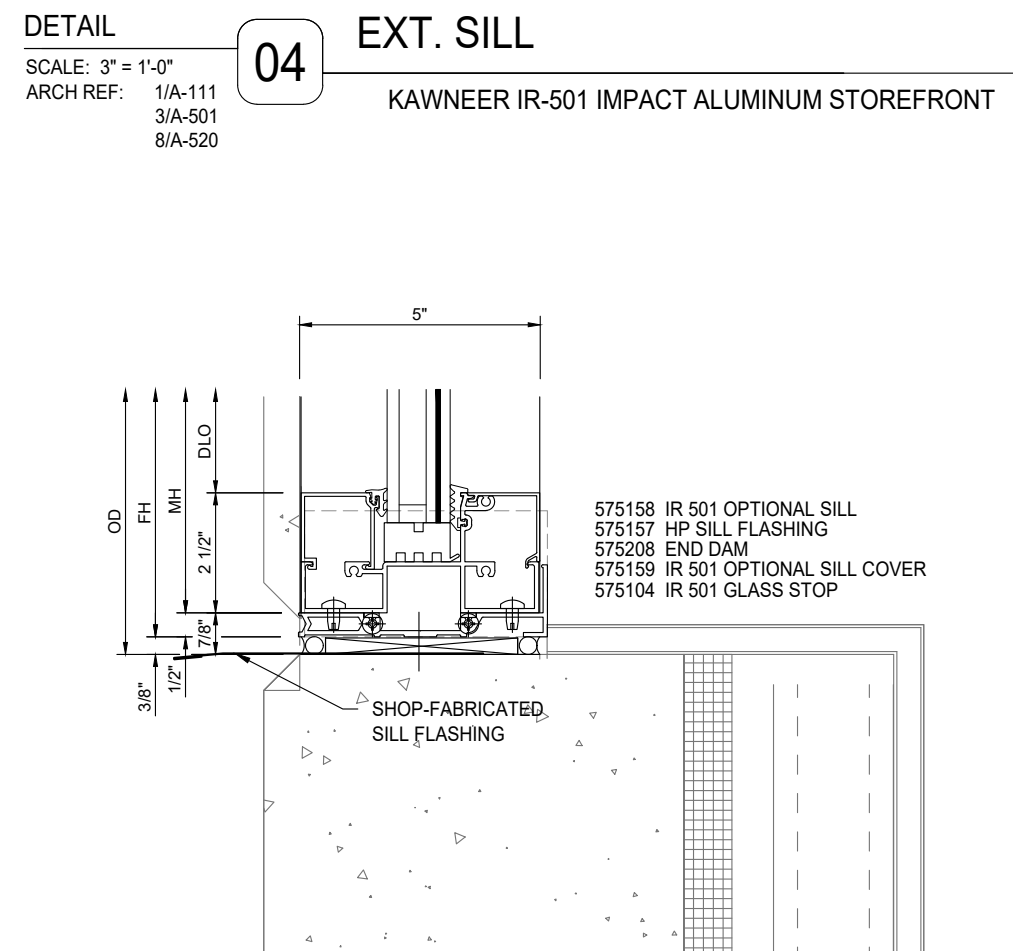

**DETAIL 04 EXT. SILL**  
SCALE: 3" = 1'-0"  
ARCH REF: 1/A-111  
3/A-501  
8/A-520  
**KAWNEER IR-501 IMPACT ALUMINUM STOREFRONT**

NO.	DATE	BY	DESCRIPTION
1	04/28/23	fp	First Submittal

**EVINS GLASS SERVICE, INC**  
101 N.P.I.D., CORPUS CHRISTI, TX 78406  
WORK (361) 884-3995 FAX (361) 884-4262

PROJECT: LYB-CCO EQUICSTAR CHEMICALS  
**LABORATORY AND OFFICE COMPLEX**  
ARCHITECT: BURROW GLOBAL (713) 963-0830  
GENERAL CONTRACTOR: BURROW GLOBAL (713) 963-0830

PROJECT NO.	EGS-2304-02
DRAWN BY	fp
DATE	04/28/23
SCALE	3" = 1'-0"
DRAWING	DETAILS
SHEET	D1